



KONICA MINOLTA

# Pcounter

## Category



User & Cost  
Management

## Characteristics

- Central user and role management
- Cost assignment and chargeback
- Budget and quota management
- Detailed output and cost reporting
- Panel personalisation





# COMPREHENSIVE MANAGEMENT OF PRINT ACTIVITIES AND COSTS

**As a sophisticated printer management and accounting solution, Pcounter helps enterprises and educational organisations accurately monitor the usage of all network printers and assign print, copy, scan and fax costs to projects, departments, users and client accounts.**

Pcounter is a server-based application that can be expanded with various modules which provide flexible customisation possibilities. The optional Pcounter Embedded add-on, for example, seamlessly integrates Pcounter server functionalities into the panel of all networked bizhub output systems (MFPs). In this case, authentication and secure pull-printing are available directly on the MFP touch panel. Ensuring streamlined user logins and advanced usability, this provides a direct link between the Pcounter server software and any connected OpenAPI-capable bizhub device.

Another optional add-on is the Pcounter Mobile Print Release app for iOS devices. With this, users can conveniently release any of their documents stored on the Pcounter server on a connected MFP of their choice – flexibly, with complete mobility and without first selecting a print queue.

When they opt for Pcounter, enterprises will find it easy to implement central user and role management, adopt efficient cost assignment and chargeback, upgrade their print infrastructure with reliable budget and quota management, and visualise all print activities with detailed output and cost reporting.

Additional Pcounter modules	
<b>Pcounter Embedded</b>	Personal print queue access via the bizhub touch screen; embeds functionalities like user authentication, pull-printing and accounting into the device display.
<b>Pcounter Workstation Manager</b>	Enables accounting of print jobs sent via direct print by monitoring print activities on devices not connected to Pcounter.
<b>Pcounter Web Report</b>	Easy Web-interface access to advanced overviews, reports and graphs; facilitates statistics and analysis from any workstation within the network.
<b>Pcounter Web Cashier</b>	Enables staff without administrator rights to manage Pcounter user accounts from any workstation, e.g. deposit or withdraw money, create user accounts, print receipts, etc.
<b>Pcounter WebPay</b>	Allows users to recharge their accounts via the Internet without involving staff; an important feature for academic institutions.
<b>Pcounter Custom Data Kit</b>	Enables Pcounter integration with existing information systems and business processes, by utilising the Pcounter API.
<b>Pcounter Custom Data Kit Connect</b>	Allows the customer to replace the Pcounter user account balance with an external database or micro-payment solution, which is then used by Pcounter.
<b>Pcounter Print Release App</b>	Allows users of iOS devices to print documents from the Pcounter server on a connected MFP of their choice without preselecting a print queue.

# KEY FEATURES

## Central user and role management

- **Central database:** All users with access to MFPs to print, copy, scan and/or fax are centrally managed in the Pcounter database.
- **Integration with user directories:** Easy integration with existing user directories eliminates the need to create and manage users in different systems. Supported directories are Windows Active Directory, Novell Netware Servers and LDAP.
- **Permission templates:** These are easy to create and facilitate the management of the different device access levels and functionalities available to users.
- **Centralised authentication management:** Authentication types can be centrally managed at the device. Whether this concerns card authentication, user credentials or convenient PIN authentication, the administrator can centrally define which type of user authentication should be in use.

## Cost assignment and chargeback

- **Basic print accounting and monitoring:** Real-time tracking of all print activities in the network is possible, and comprehensive print histories can be created without requiring any additional clients.
- **Advanced print, copy, scan and fax accounting:** This is available either via OpenAPI through Pcounter Embedded, or through external PayCon terminals.
- **Automatic tracking:** Via the central counter collection, all copy, print, scan and fax activities can also be tracked for all users, groups and cost centres or projects. Covering the whole printing infrastructure, print job tracking for non-Konica Minolta devices is also supported.
- **Management of pricing tables:** Multiple pricing tables can be flexibly assigned to devices (one or several print queues per device, depending on the Pcounter configuration), allowing an accurate calculation of print costs for a heterogeneous print infrastructure. Users can be assigned to a specific cost centre or can flexibly select an appropriate cost centre or project before printing.
- **Pcounter Workstation Manager:** This optional add-on is installed on the Pcounter server to enable accounting of print jobs sent via direct print. The Workstation Manager Client is installed on the user side, where it monitors and tracks all print activity of devices not connected to Pcounter.



## ■ Budget and quota management

- **Easy quota assignment:** Assigning certain budgets or quotas to individual users or user groups enables limiting individual printing activities to be limited and helps organisations to keep control of print, copy, scan and fax costs.
- **Periodical quota reset:** Quotas can automatically be reset on a periodical basis. To enable exceptional printing, the administrator can also manually reset or accumulate quotas.
- **Cash reload terminal (optional):** Connecting one or more of these terminals provides users with the possibility to pay cash (notes & coins) into their Pcounter account for immediate recharging of their credit.
- **Pcounter Web Cashier (optional):** Providing enhanced user & budget management, this add-on enables non-technical staff to handle everyday operations such as creating user accounts, printing receipts, viewing a detailed history of all transactions, etc. from anywhere via a logically structured Web interface. In this way, office workers without administrator rights can also manage Pcounter user accounts.
- **Pcounter WebPay (optional):** This online payment service lets users recharge their accounts themselves via the Pcounter Web interface without involving staff. This is an important requirement, especially in academic institutions. The Web interface can easily be customised to correspond to the organisation's Web layout.

## ■ Detailed output and cost reporting

- **Report creation:** The application enables detailed overviews and text-based reports to be flexibly created on activities of individual users or user groups and the related costs per day, week, month or longer periods.
- **Export of reported data:** For accounting purposes, results can be reported in various formats (csv, html, xml, xls). With the optional Pcounter Web Report add-on, additional formats such as pdf, doc, ppt and others can also be exported.
- **Pcounter Web Report (optional):** This module enables transparent cross-referencing between cost centres and users. It enables advanced overviews to be accessed, detailed reports and graphics to be created, and also allows the analysis of complex statistics via Web interface from any workstation within the network. This tool enhances the analysing capabilities of all activities recorded by Pcounter and provides users with comprehensive visualisation capabilities. With a convenient scheduling function, reporting can also be automated.





## WORKFLOW

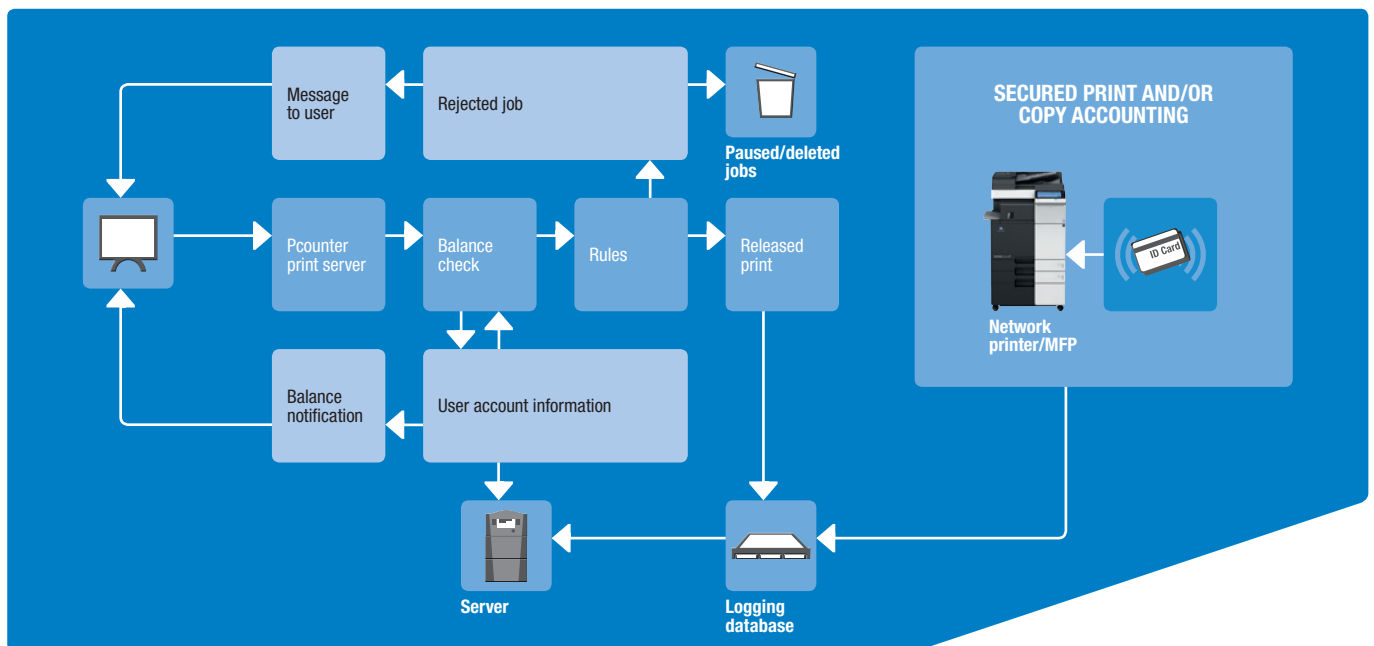



# TECHNICAL SPECIFICATIONS

## ▀ Pcounter – Version 2.71a for Windows, Version 5.53 for Netware

### SYSTEM REQUIREMENTS

<b>Operating systems</b>	Windows XP Professional (32/64) Windows Vista Business (32/64) Windows Vista Ultimate (32/64) Windows 7 (32/64) Windows 2003 Server (32/64)* Windows 2008 Server (32/64)* Windows 2012 Server (64)*
<b>Memory</b>	Sufficient to run the operating systems efficiently
<b>CPU</b>	Fast enough to run the operating system efficiently
<b>Important information</b>	Pcounter server requirements will follow the Microsoft print server specifications Supports accounting of print jobs from any network workstation including MAC and Unix Supports MS Windows Active Directory environments and Novell Network eDirectory and NDPS environments Windows Cluster Support (Active/Passive)
<b>Supported languages</b>	English

## ▀ Pcounter embedded – Version 3.2.0

### SYSTEM REQUIREMENTS

<b>Operating systems</b>	Windows XP (32/64) Windows 7 (32/64) Windows 2003 Server (32/64) Windows 2008 Server (32/64) Windows 2012 Server (64)
<b>.NET Framework</b>	.Net Framework 2.0 (minimum) .Net Framework 3.0 if bEST link has to be supported
<b>Web browser</b>	Mozilla Firefox Google Chrome Opera Microsoft Internet Explorer version 8 or higher
<b>Prerequisites</b>	Windows: Pcounter 2.62c (minimum) Netware: Pcounter 5.51a (minimum)
<b>Important recommendations</b>	A server operating system is recommended for the installation of Pcounter embedded. Windows Cluster Support (Active/Passive)
<b>Supported languages</b>	English, French, Italian, German, Spanish, Dutch, Swedish

\* recommended operating systems

## **Pcounter Web Report – Version 3.2.2**

### SYSTEM REQUIREMENTS

<b>Operating systems</b>	Windows XP Professional SP3 (32/64) Windows Vista (32/64) Windows 7 (32/64) Windows 2003 Server (32/64) Windows 2008 Server (32/64)
<b>Hard disk space</b>	150 MB
<b>CPU</b>	Fast enough to run the operating system efficiently
<b>.NET Framework</b>	.Net Framework 3.51 (minimum)
<b>Web browser</b>	Internet Explorer Mozilla Firefox (Client web browsers must have the Microsoft Silverlight plug-in installed)
<b>Prerequisites</b>	Windows: Pcounter 2.62c (minimum) Netware: Pcounter 5.51a (minimum)
<b>Supported languages</b>	English, French, German
<b>Important recommendations</b>	A dedicated server for Web Report may be required in large environments, depending on the amount of users and data processing. If Pcounter logs files of 50–100 MB or greater per month it is necessary to have a dual core processor and 4–8 GB RAM (8 GB preferred).

## **Pcounter Web Cashier – Version 3.2.1**

### SYSTEM REQUIREMENTS

<b>Operating systems</b>	Windows XP Professional (32/64) Windows 2000 Professional (32/64) Windows Vista (32/64) Windows 2000 Server (32/64) Windows 2003 Server (32/64) Windows 2008 Server (32/64)
<b>Memory</b>	1 GB
<b>Hard disk space</b>	500 MB
<b>CPU</b>	Fast enough to run the operating system efficiently
<b>Web browser</b>	Internet Explorer 5.5 (minimum) Mozilla Firefox 1.0 (minimum) needs to be installed on client PC for accessing Web Cashier
<b>Prerequisites</b>	Windows: Pcounter 2.62c (minimum) Netware: Pcounter 5.51a (minimum)
<b>Supported languages</b>	English, French, German, Spanish, Danish

## **Pcounter Mobile Gateway – Version 1.0.1**

### SYSTEM REQUIREMENTS

<b>Operating systems</b>	Windows 2003 Server SP2 (32/64) Windows 2008 Server SP1 (32/64) Windows 2008 Server R2 (32/64) Windows 2012 Server (64)
<b>Memory</b>	1 GB
<b>Hard disk space</b>	5 GB
<b>CPU</b>	Recent server CPU generation (Intel Xeon 64 or equivalent)
<b>Prerequisites</b>	Pcounter 2.55 (minimum) for Windows has been installed and configured No anti-virus program monitoring or interrupting the Pcounter Mobile Gateway directories
<b>Supported languages</b>	English





## **Pcounter Custom Data Kit (CDK) – Version 2.2.24/Custom Data Kit Connect (CDK Connect) – Version 1.1.4.0**

### SYSTEM REQUIREMENTS

<b>Operating systems</b>	Windows XP Professional (32/64) Windows Vista (32/64) Windows 2003 Server (32/64) Windows 2008 Server (32/64)
<b>Hard disk space</b>	20 MB (minimum and installed)
<b>Prerequisites</b>	The CDK and CDK Connect must be installed on the Pcounter data server (Windows) and the Pcounter server must have a valid Pcounter license with ongoing maintenance
<b>Important recommendations</b>	CDK log expert requires approximately 10 times the 20 MB hard disk space used by the Pcounter log (i.e. Log size is 1 MB = 10 MB required) CDK database may require 1 KB temporary disk space for each client code imported
<b>Supported languages</b>	English

## **Pcounter WebPay Gateway – Version 2.9**

### SYSTEM REQUIREMENTS

<b>Operating systems</b>	Windows XP Professional (32/64) Windows 2000 Professional (32/64) Windows 2000 Server (32/64) Windows 2003 Server (32/64) Windows 2008 Server (32/64) Windows 2012 Server (64)
<b>Hard disk space</b>	25 MB
<b>CPU</b>	Fast enough to run the operating system efficiently
<b>Prerequisites</b>	Windows: Pcounter 2.62c (minimum) Netware: Pcounter 5.51a (minimum)
<b>Installation prerequisites</b>	The WebPay Gateway must be installed on the same computer that hosts the Pcounter data server service. For Pcounter for Netware, the WebPay gateway must be installed on a Microsoft Windows computer with the Novell client
<b>Supported languages</b>	English

